



Nundah State School

This document is part of Nundah's BYO iPad setup guides.

For all documents and further information please visit:

<https://nundahss.eq.edu.au/curriculum/iPad-program/parent-setup-guides>

Setting up Screen Time and Content Restrictions

This is the **3rd guide** when setting up your child's iPad.

Please note: If you are in the process of setting up your child's iPad, you may have already completed the first part of this step when setting up your child's account using Family Sharing. Please complete Step 1 then begin on page 5 – Down Time to review settings as appropriate

Setting up Screen Time

Screen Time is a feature that allows you to monitor and control your own and your child's use of Apple Mobile Devices (iPhones and iPads).

Step 1:

- ☐ If completing on the child's device, open 'Settings'. If setting up from your Apple device see below.
- ☐ Select 'Screen Time' from the left menu.- You may need to scroll down to find it.

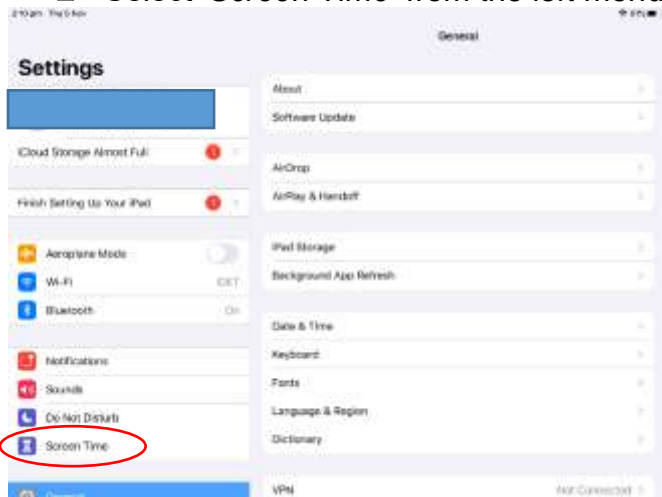

Setting up Screen Time from a Parent/Carer's device.

You may also set up Screen Time and Content Restrictions from another Apple device if they are connected through Family Sharing.

1. Tap on 'Your name' in the top of the left menu in Settings.
2. Select 'Family Sharing'.
3. Tap on the child's account that you wish to set up.
4. Select 'Screen Time'.
5. A pop up box will appear similar to the image to the left - Press 'Continue' and follow the steps as outlined in this document (excluding Step 3). If you have already set this up in the initial setup, skip to Step 10.

Step 2:

- ☐ Select 'Continue' / 'Turn on Screen Time'

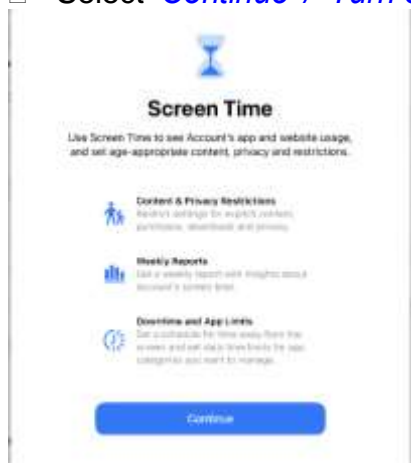

Step 3:

- ☐ If prompted, select '*This is my Child's iPad*'

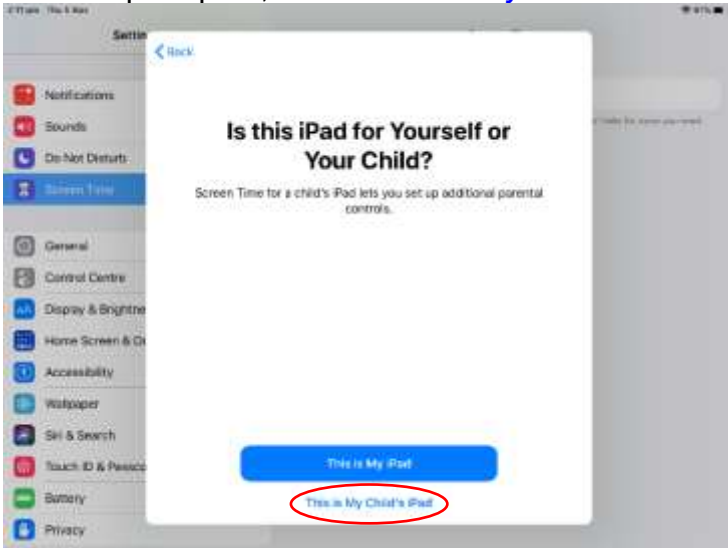

Step 4:

- ☐ Choose an appropriate age for your child. This affects what apps are visible in the App store and on the child's device. If a school app is missing, please ask for support.
 - ☐ Adjust the options as needed.
 - Scroll to see more options
 - Ensure Web Content is set to '*Limit Adult Websites*'
- Please Note:** 'Allowed websites only' can impact on your child's ability to access educational sites and research at school.
If you are concerned about internet access at home, consider limiting Safari through the use of 'App limits' outlined later in this guide.
- ☐ Select '*Turn On Restrictions*'

< Back

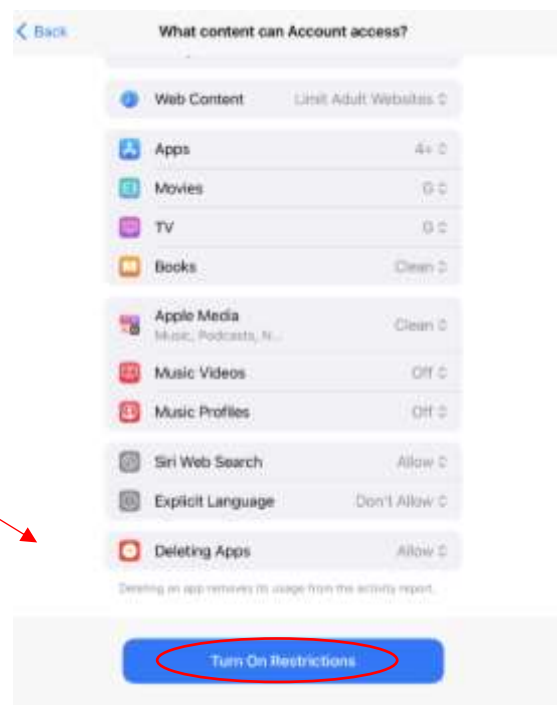
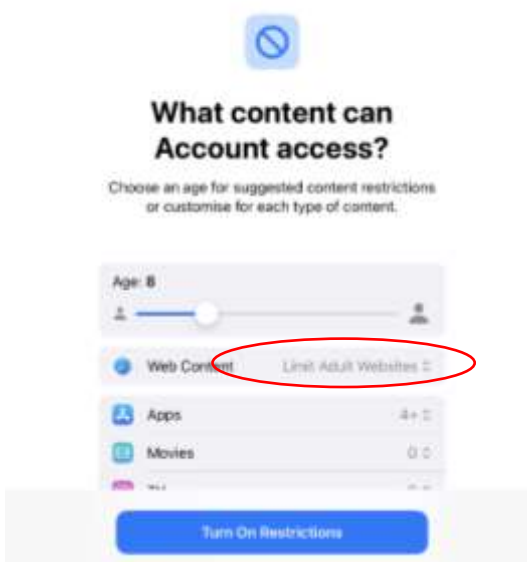

Step 5: Health and cyber safety features

- ☐ Press '[Continue](#)' to enable Sensitive Photos and Videos Protection
- ☐ Press '[Continue](#)' to enable Screen Distance

[← Back](#)

[← Back](#)

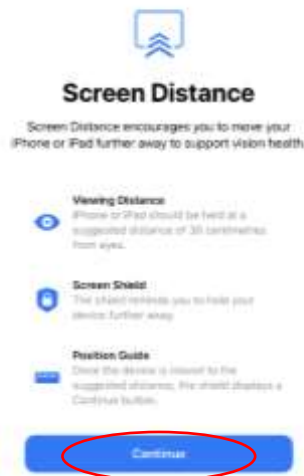

Step 6: Screen Time

- ☐ Press '[Turn on Apps & Website Activity](#)'

[← Back](#)

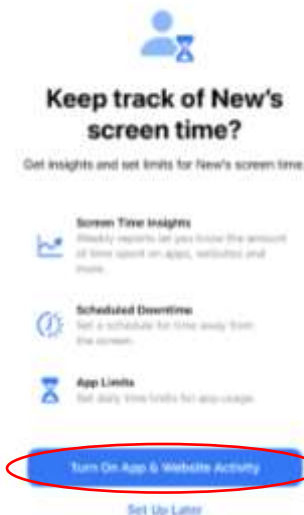

Step 7: Downtime

- ☐ Select an age appropriate '*Down Time*' for your child.
 - During this time, only apps you choose can be used.
- ☐ To adjust the time, simply click on the Start/End time and scroll to your preferred times.
- ☐ Select '[Turn On Downtime](#)'.

Step 7: Downtime (continued)

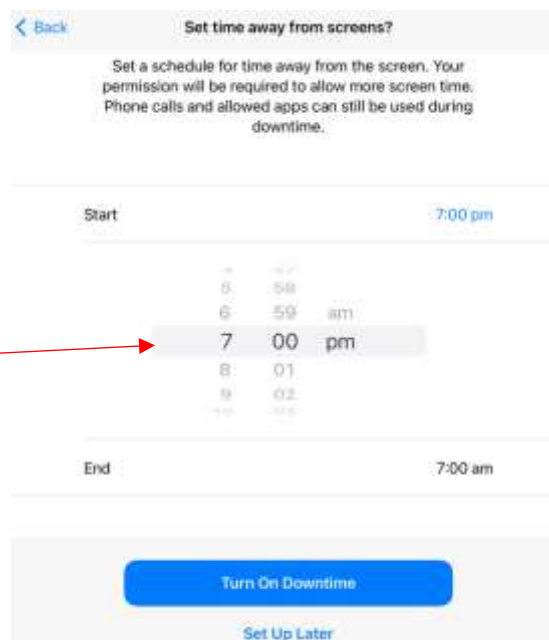
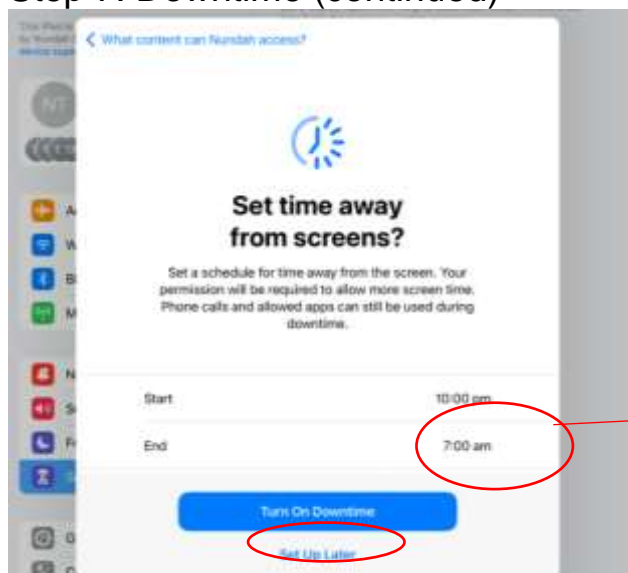

Step 8: App Limits

- Click 'Set Up Later'.

We will come back to this in a few steps as it is easier then.

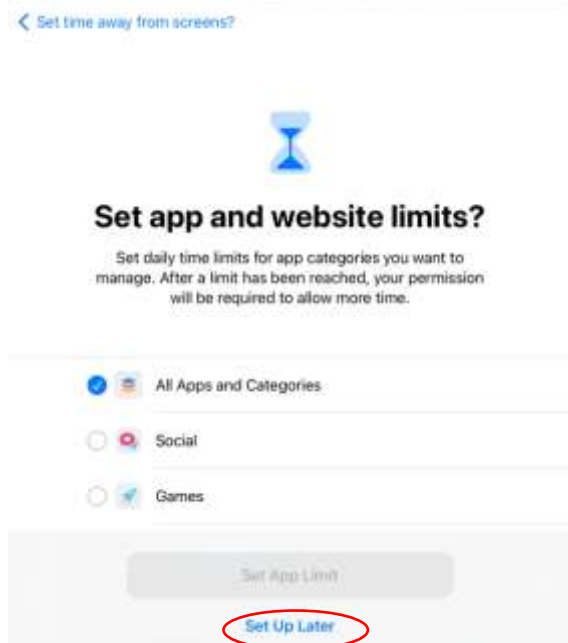

Step 9: Passcode

- Create a passcode for Screen Time. N.B. **This should be that is different to your child's iPad passcode.**
- Record it somewhere safe as the school cannot help you to recover this.

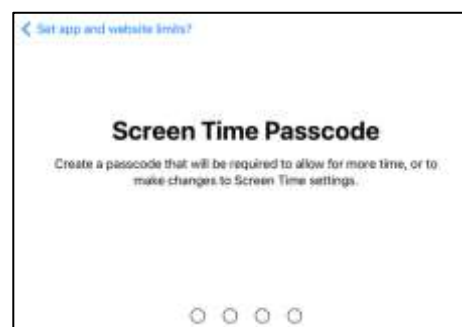

Step 10: Downtime

You can make adjustments to Downtime, or if you did not complete Down Time setup earlier, you can turn it on here.

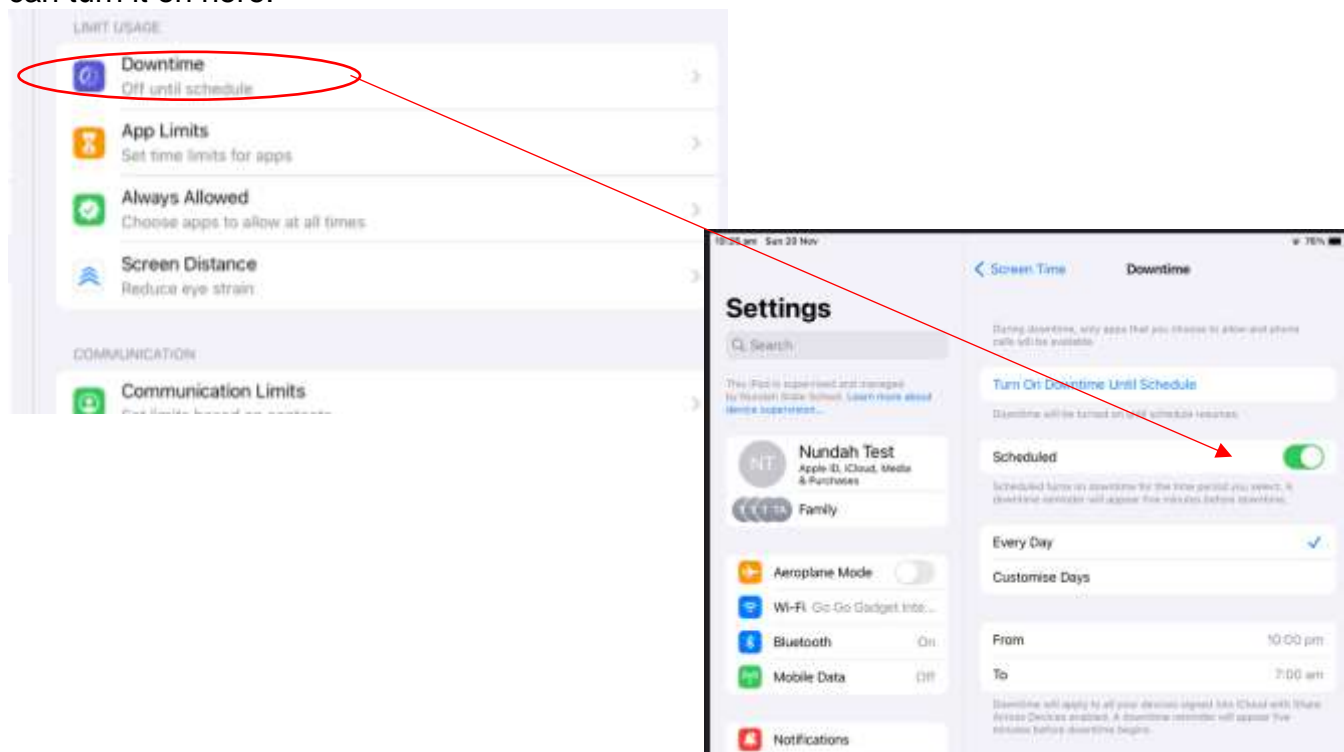

An example of what apps look like during 'App Limits' or 'Downtime' is shown below.

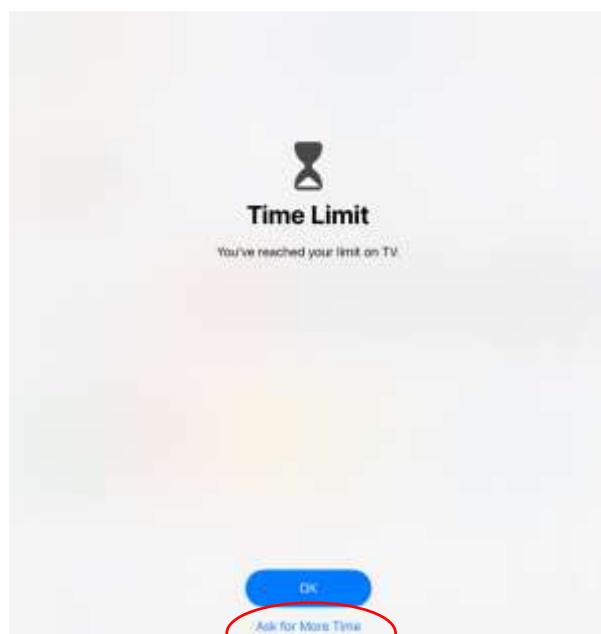
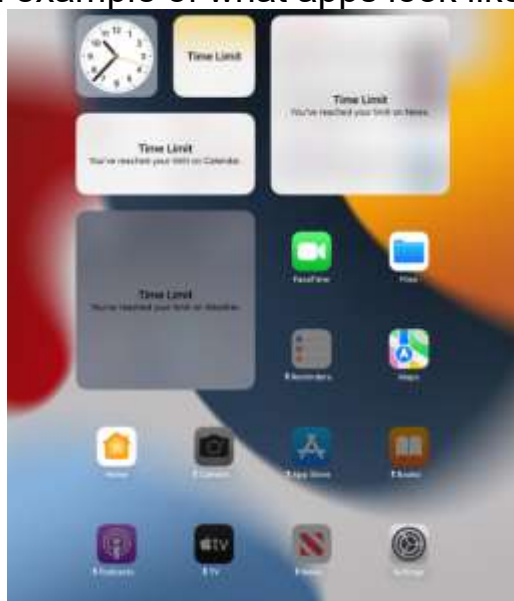

Children may request Additional time when Down time is active.

Initially they may be able to use the app for OneMore Minute, but once that has been used, the child must either send a request to an adult Apple device (must have set up the child's device using family sharing' or by asking the adult to enter the Screen Time Passcode that was chosen earlier.

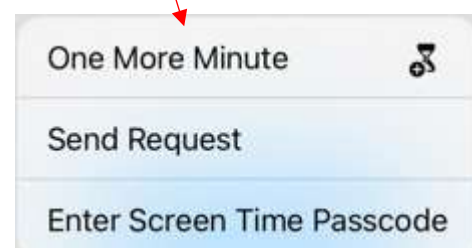

Step 11: App limits

- Return to the Screen Time menu, and select 'App Limits'

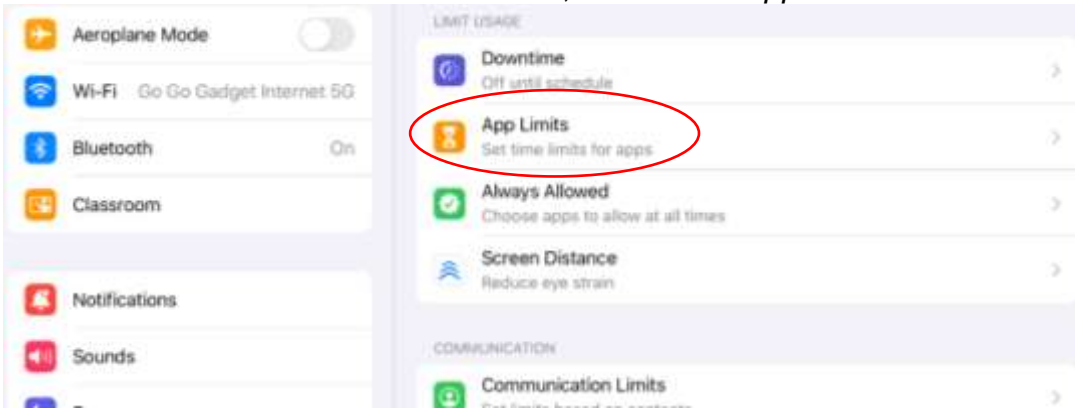

- If prompted, slide the App limits toggle on (green), otherwise select 'Add Limit'
- You may be required to put in the passcode you set earlier.

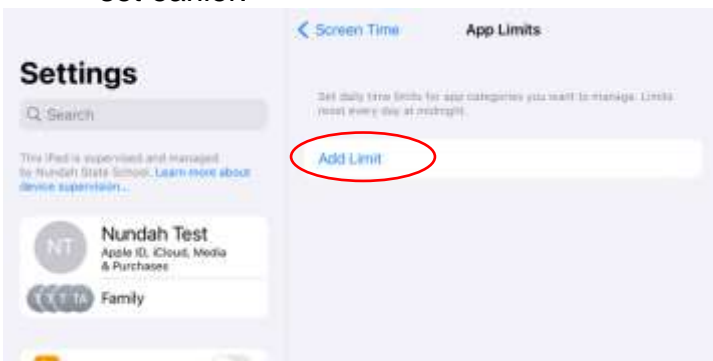
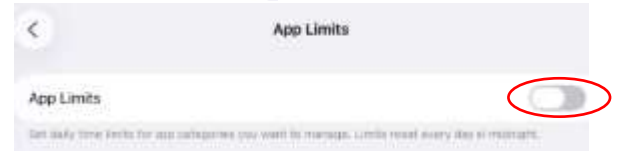

- Select the apps you wish to place a time limit on.
- This can be done by selecting a category, or by selecting individual apps.

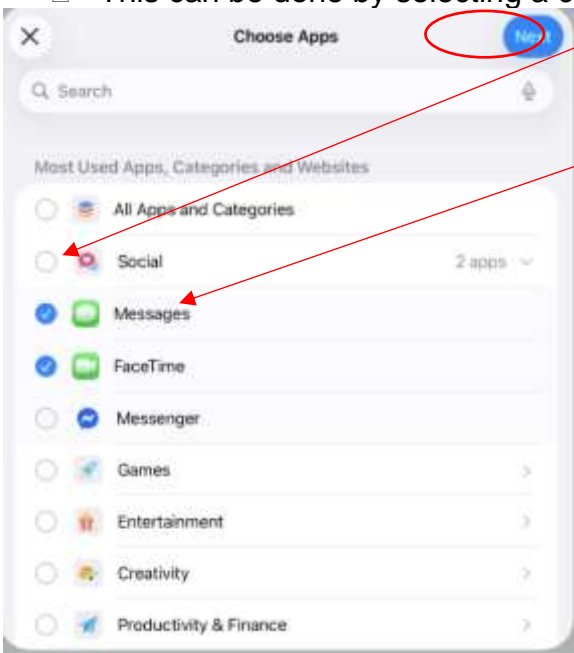

- You can also set app limits for specific websites by scrolling to the bottom of this list.

- Then select 'Next'

Step 11: App limits (continued)

- Choose the desired amount of time.
- ***OPTIONAL*** If you wish to place different time limits for different days (e.g. more/less time on the weekend), then select 'Customise Days'
 - This will require you to choose a time for each day of the week.

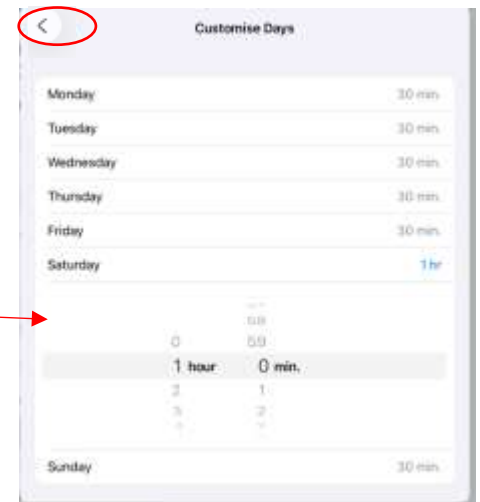
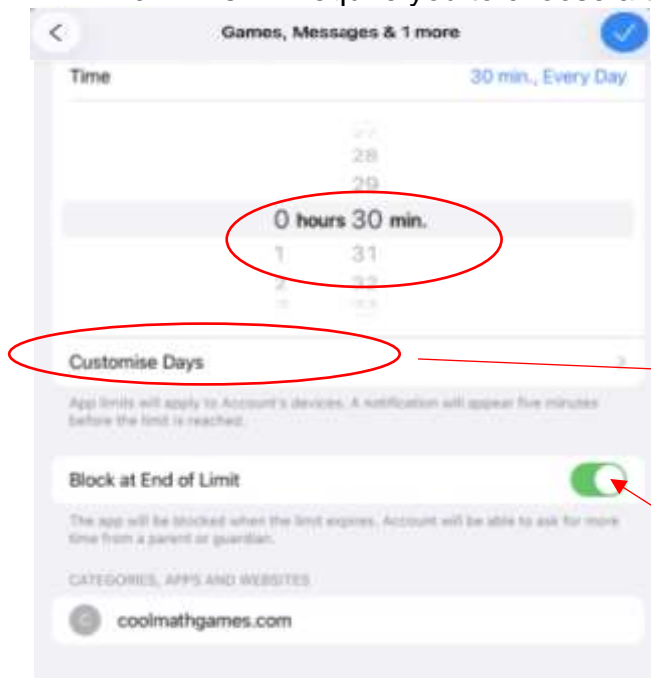

If it appears, toggle 'Block at End of Limit' to green.

This will disable the app at the end of the time allowed. If turned off, children will simply receive a notification saying they have used their allowed time and can ignore this notification and continue with the app/ website.

- Select '**the blue tick**' to continue



- Repeat this step for other apps using different time limits if needed.
- Then select '< Screen Time' to continue.

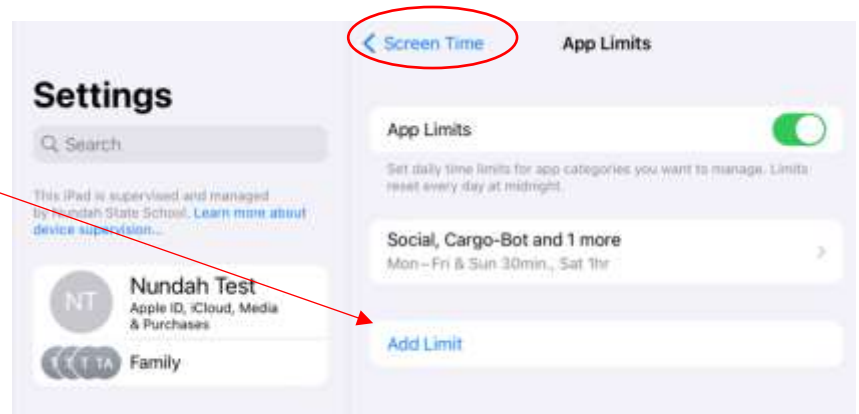



Please note: You may set these restrictions to times you choose. If these limits impact your child's learning, your class teacher will reach out to discuss options with you.

Step 12: Always Allowed

Use this feature to choose which apps can be accessed during Downtime.

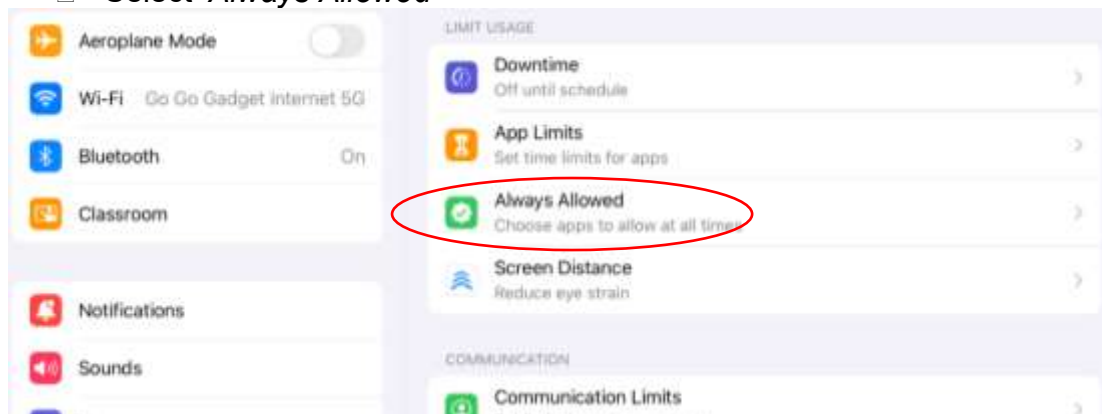
- Select 'Always Allowed'



- To remove an app, click the  icon next to the name of the app.
- To add an app to be accessible during down time, click the  icon next to the name of the app.

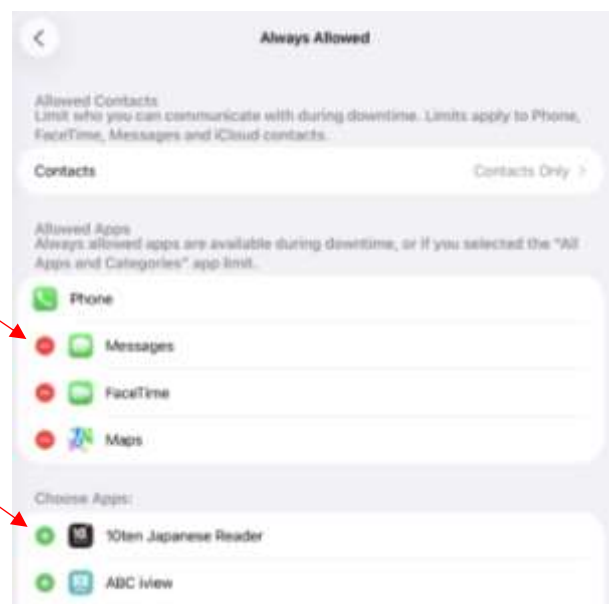

N.B. Phone cannot be removed.

However, you can limit the contacts that can be contacted when the iPad has Downtime active. You can do this by clicking 'Contacts' on this screen or in the section 'Communication Limits'. How to do this, is explained in Step 14 on the next page.

Step 13: Screen Distance

This feature is enabled by default. If you wish to turn it off, click on 'Screen Distance' and toggle the green switch to grey.



Step 14: Communication Limits

If you wish to limit which contacts can be used, either all the time or during Downtime, complete this step.

- Select '*Communication Limits*'

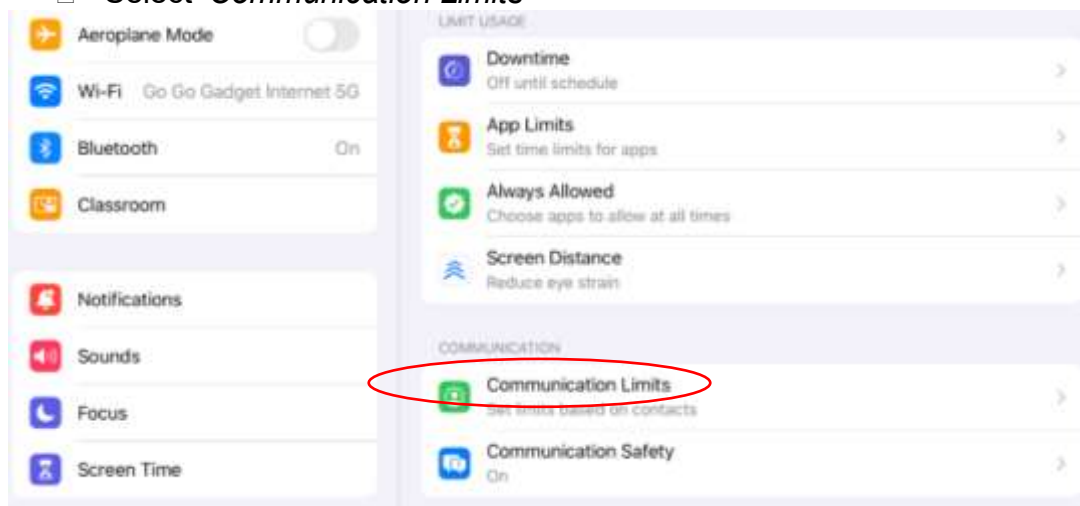

- Select '*During Screen Time*'

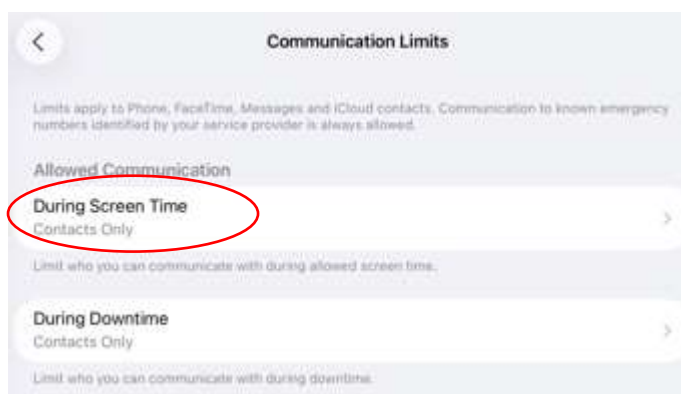

This section may appear different if setting up from a parent's device.

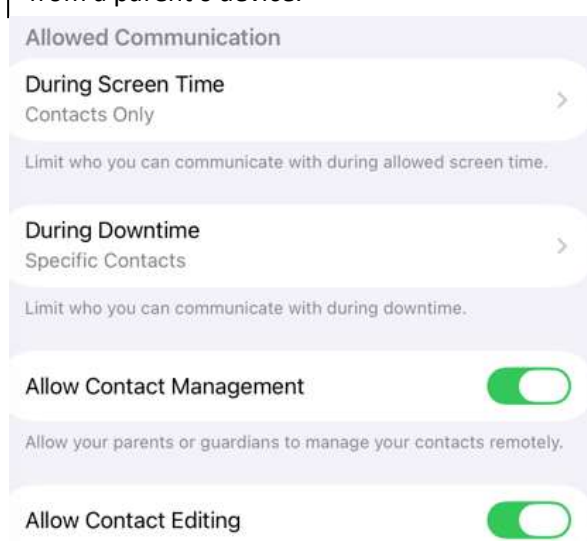

- Select your preferred option from the list. This will automatically update the Allowed Communication for 'During Downtime'
- Select '<' to return to the previous screen.

- Select '*During Downtime*'

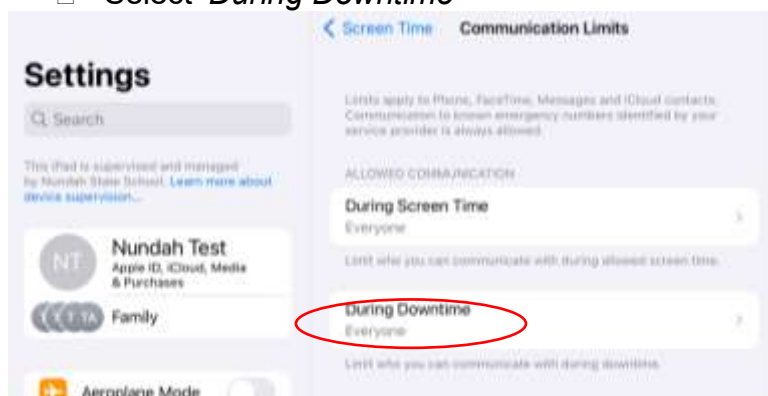

Step 14: Communication Limits (continued)

During Downtime

In this feature, you can limit the contacts to specific contacts. If you wish to do this, follow the below steps.

- ☐ If contacts are already loaded on the iPad, or if completing this using an adult's device where the contact is saved, click '[Choose From My Contacts](#)'
- ☐ Else, click '[Add New Contact](#)'

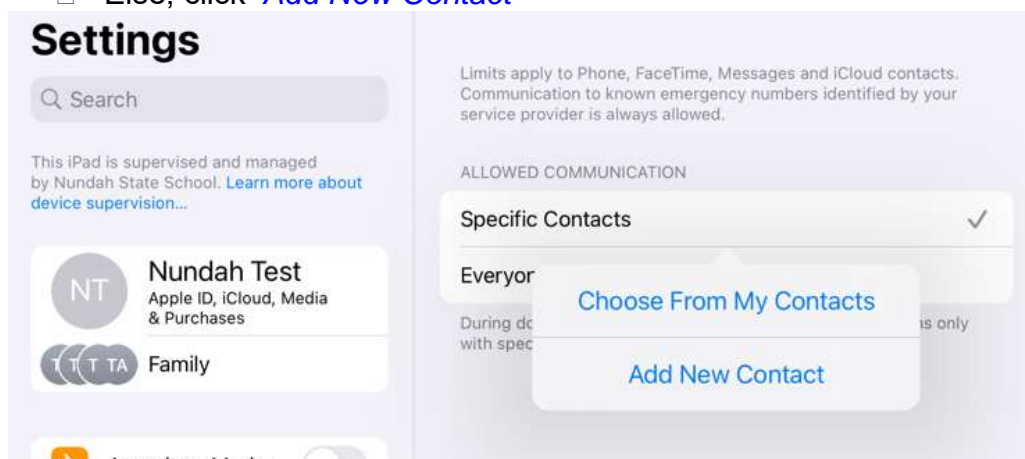

- ☐ Select or enter the details for the contact and press done.

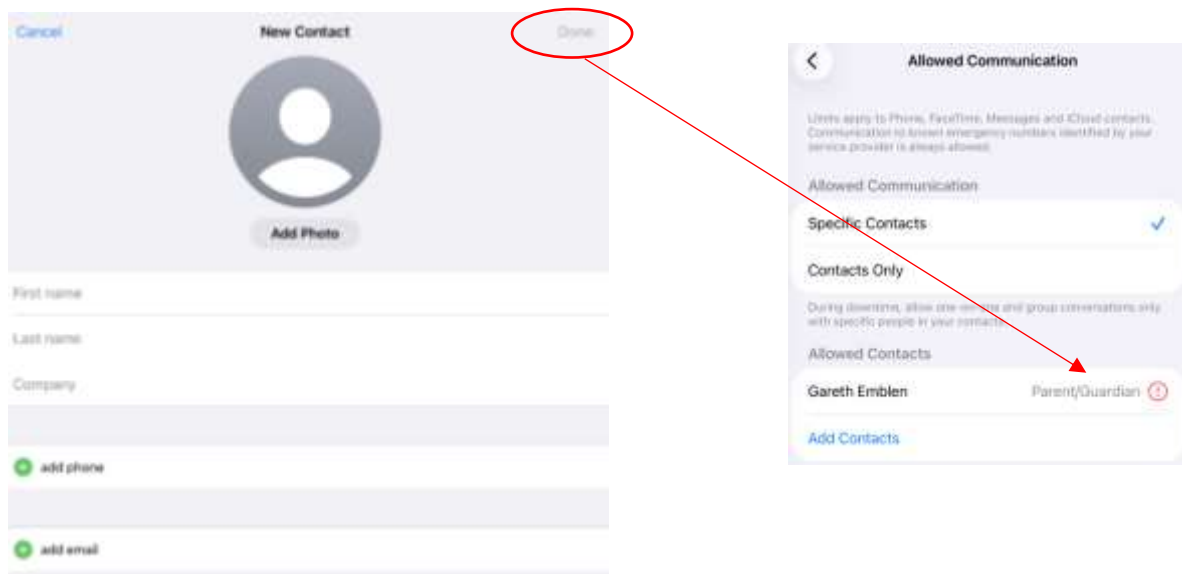

Step 15: Communication Safety

This feature may not be visible on older iPads or those not set up using family sharing. It may have also been enabled during the initial set up.

- ☐ Select '[Communication Safety](#)'

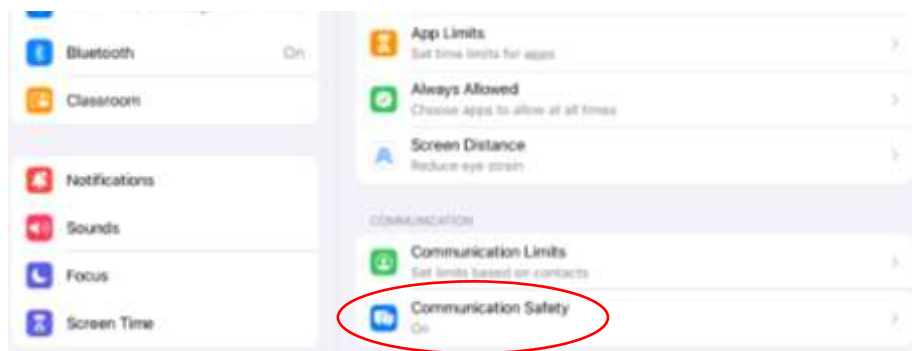

Step 15: Communication Safety (continued)

- ☐ If prompted, read the information and select '[Continue](#)'
- ☐ Then select '[Don't Share](#)'

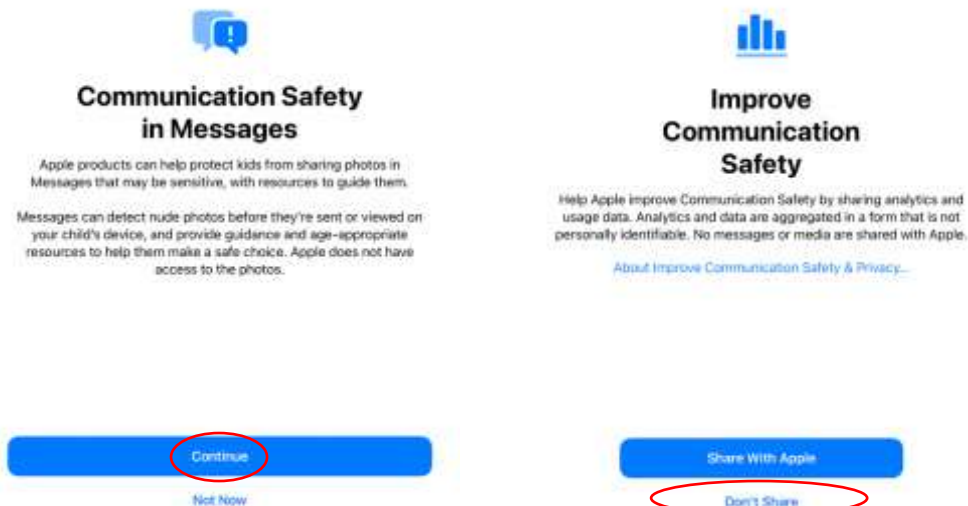

- ☐ If the above prompts don't appear, make sure the top option is toggled to 'green'

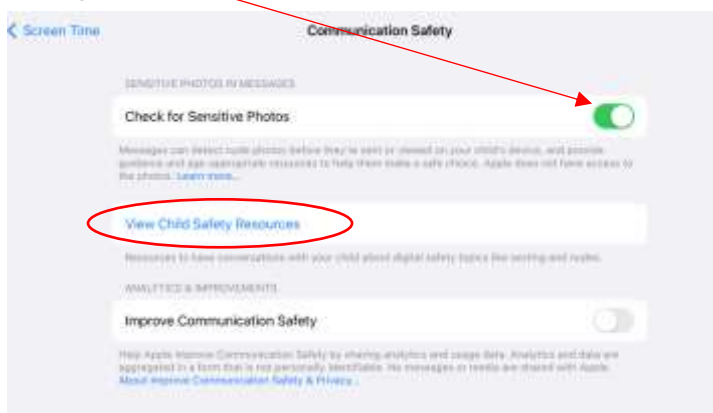

Clicking on '[View Child Safety Resources](#)' brings up a link to the website of the Office of the eSafety Commissioner with resources for kids.



Step 16: Notifications on adult devices (ADULT'S DEVICES ONLY)

If you are using 'Family Sharing', please check your notifications on **your device** are set to receive messages from 'Screen Time'. This will allow you to receive requests from your child's device.

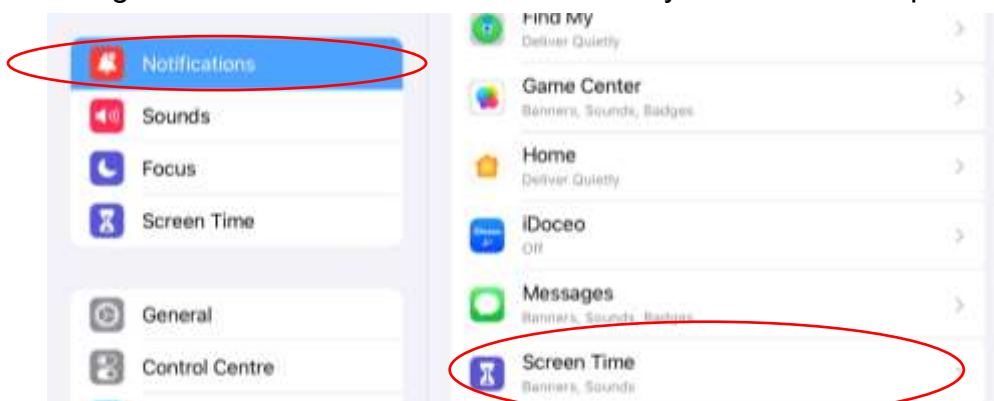

Nundah State School
41 Bage Street, Nundah QLD

Phone: 3635 5888 Email: studentsupport@nundahss.eq.edu.au

Setting up Content and Privacy Restrictions

Step 17:

- Select 'Content and Privacy Restrictions'

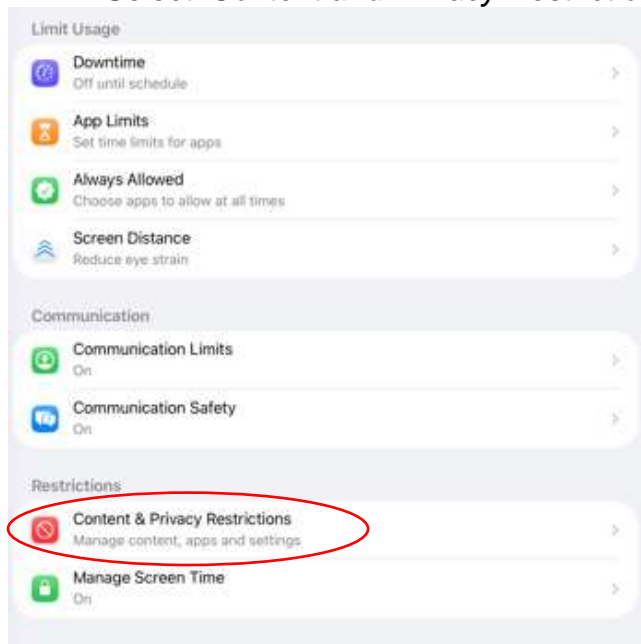

Step 18:

- If it is not already, Slide 'Content & Privacy Restrictions' to on (green).

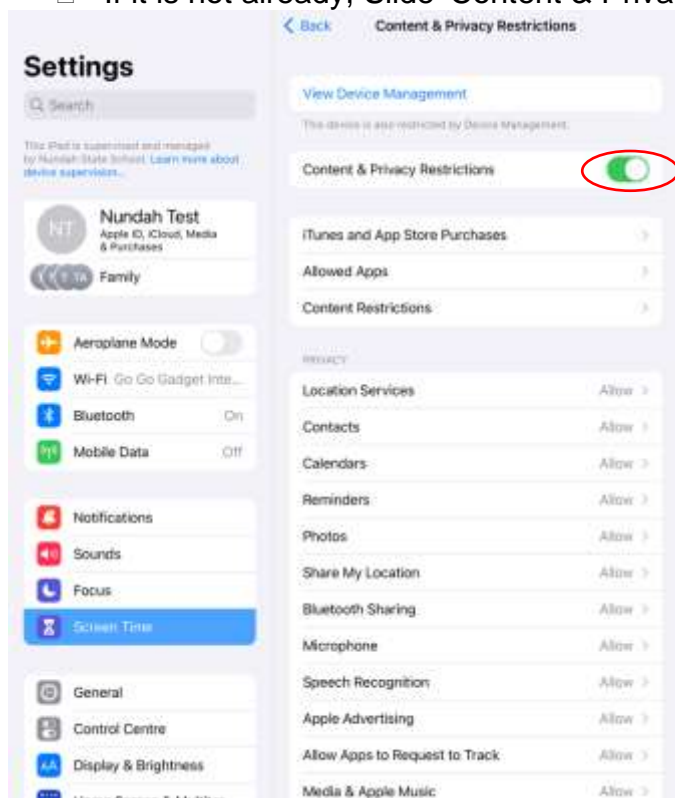

If you are completing these steps on a parent device, there may be fewer options in the privacy section. Please note, these are settings for restricting the changes of Privacy settings.

You may wish to check these on your child's iPad before you disable the ability to make changes.

Step 19:

- Select '*iTunes and App Store Purchases*'

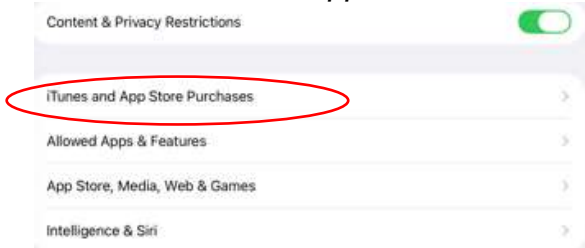

- Enter your Screen Time passcode if prompted.

Step 20:

- Set '*Deleting Apps*' and '*In-app Purchases*' to Don't Allow
- Set '*Require Password*' to Always Require
- Select '<'

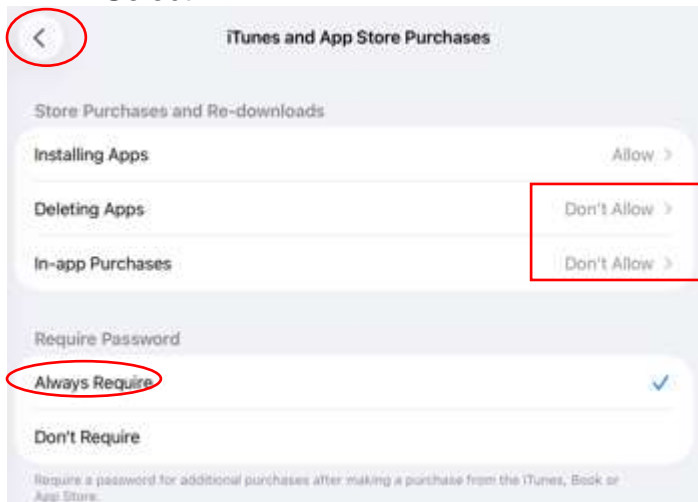

N.B.

Turning off '*Installing Apps*' will remove the App Store from your child's iPad.

Step 21:

- Select '*Allowed Apps and Features*'

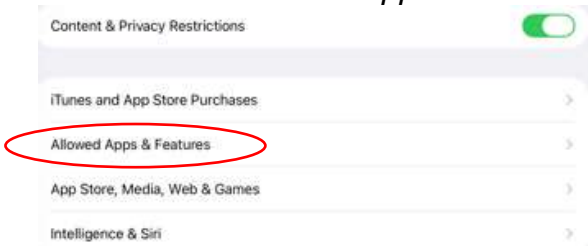

Step 22:

- Swipe the following Apps to allow (green). These are used at school.
 - Mail
 - Safari
 - Camera
 - AirDrop
- All other Apps are at your discretion
- Select '<' to return to the previous menu

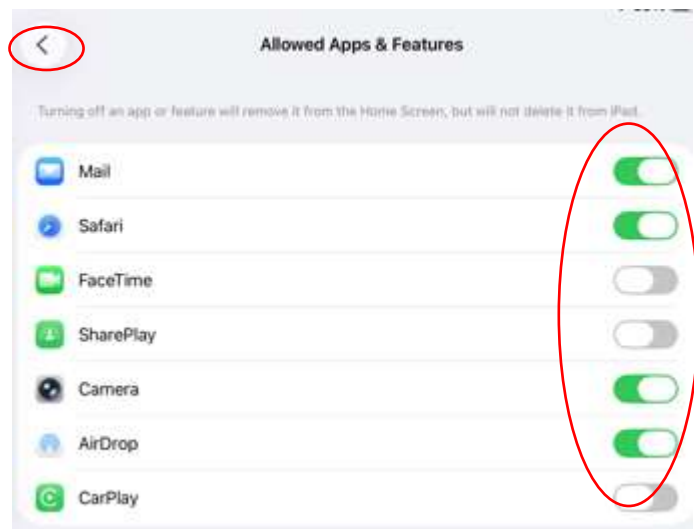

Step 23:

- ☐ Select 'App Store, Media, Web & Games'

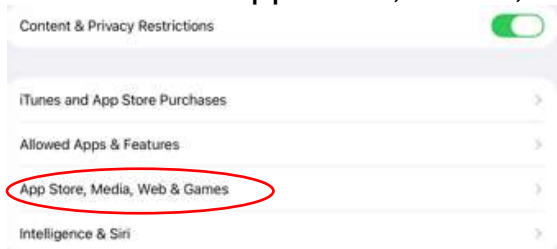

Step 24:

- ☐ Set ALL restrictions as shown in the image below.
- ☐ Select < Back

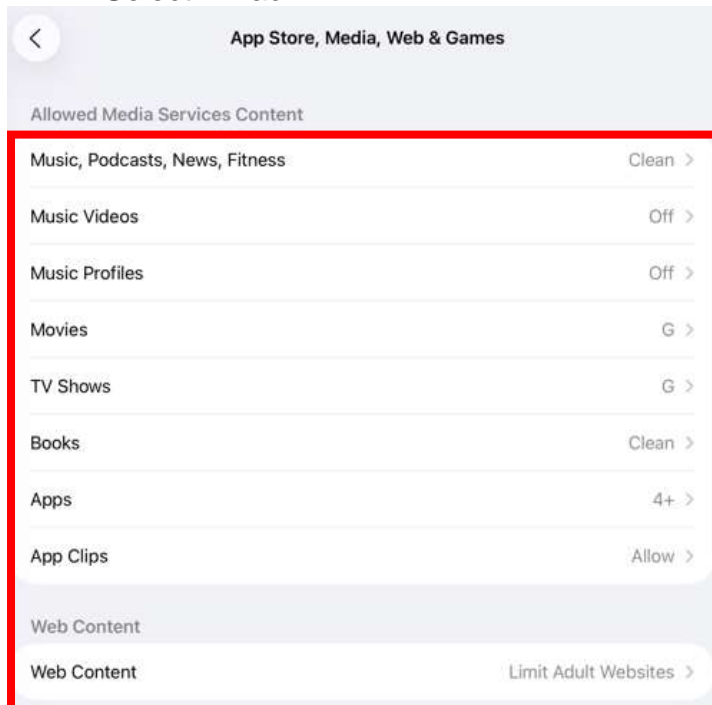

Please Note: Changing 'Web Content' to 'Allowed Websites' can cause problems with research tasks and other web-based tasks at school.

For this reason, we encourage parents to choose 'Limit Adult Websites'.

- ☐ This will filter websites according to Apple's filters.
- ☐ You can also block particular websites by clicking 'Add Website' in never allow.

When connected to the school network, students are also restricted through the school's high level filtering system.

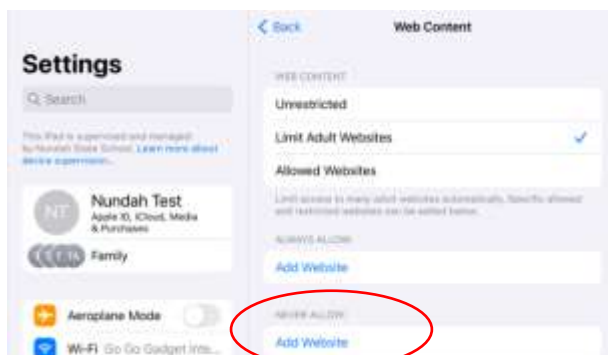

If you after stronger web filtering options at home, you may be able to impose limits through your router, through your antivirus provider or through a commercial filtering platform or app.

Step 24 continued

- ☐ Scroll down to see the Game Center options
- ☐ Set options in the Game Center categories as preferred. Game Center is not required for any school apps. You may wish to set all other than 'Screen Recording' to 'Don't Allow'

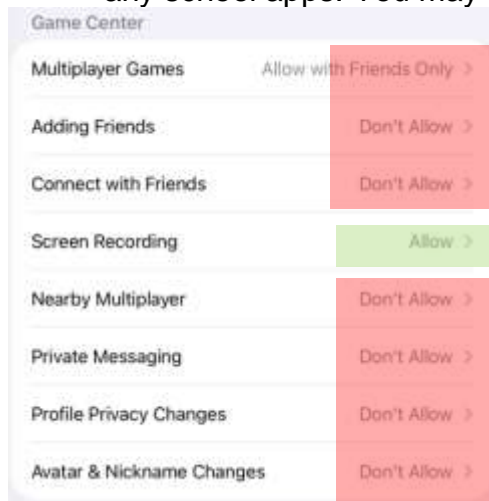

- ☐ Press '<' to return to the 'Content and Privacy Restrictions' menu

Step 25:

- ☐ Select 'Intelligence & Siri'

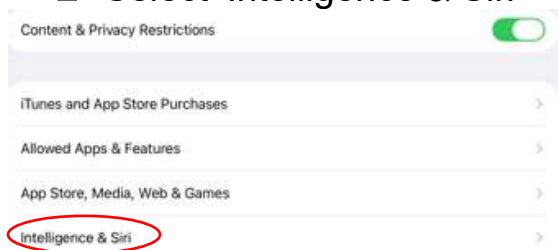

Step 26:

- ☐ Select options as preferred, except for 'Siri and Dictation' which should be enabled so students can use 'Dictation features' as part of schoolwork.
- ☐ Our recommendations are:

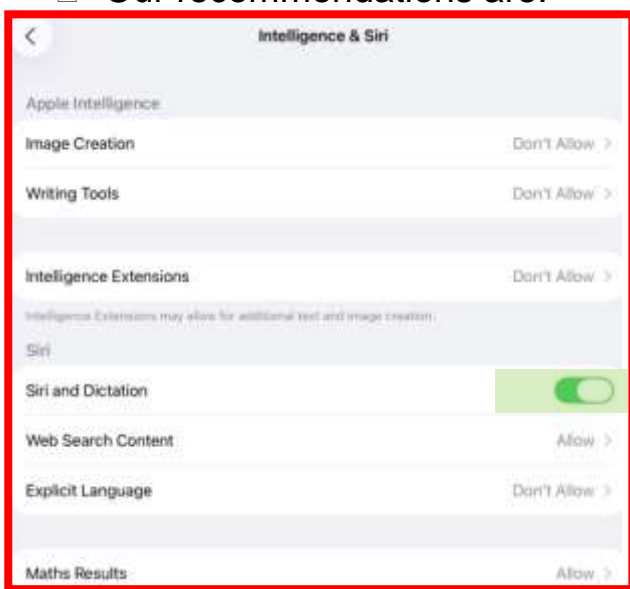

Step 27 – Privacy – These are about the child’s ability to make changes to the Privacy settings in ‘Privacy and Security’. You may wish to visit the Privacy and Security menu in Settings first (just below ‘Screen Time’ in the left menu)

☐ Set preferences as below.



These steps will appear differently from a parent’s device. To make the changes in Steps 27

- Open the settings app ON YOUR CHILD’s device,
- navigate to ‘Privacy & Security’ in the left menu
- Find the relevant headings indicated in the steps to the left.
- Then return to your device to change ‘Share my location’ to ‘Don’t Allow Changes’

For ‘Share My Location’

- **N.B.** You may choose to keep this on, however with the change to ‘Find My’ from iOS13 and on, it gave the option to make the iPad’s location visible to all contacts so children could view the location of their friends and their location could be viewed at all times
- This will not disable ‘Find My iPad’

☐ Select <

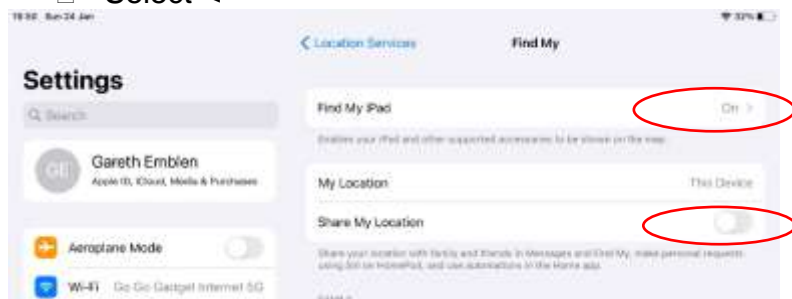

Step 28:

- ☐ Set ALL remaining restrictions as shown in the image below.
- ☐ You may wish to add your own Face/Touch ID to your child's iPad before this step.
- ☐ Please note: If your child has an issue with disabling iCloud (see General settings Parent guide), this is the step you will need to return to, in order to change 'Accounts' to Allow. It can be disabled if you have already completed the 'General Settings guide'.

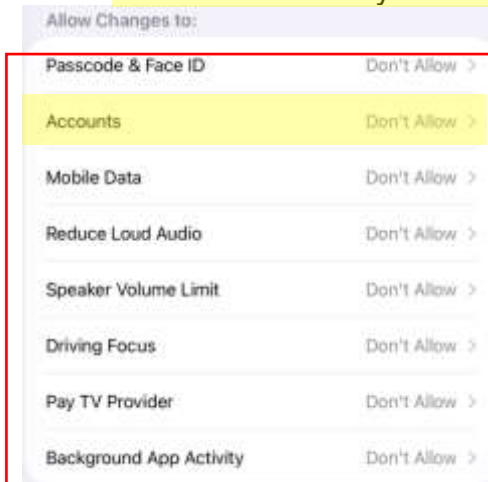

Congratulations, you have completed the Screen Time and Parental Controls guide.

The final step is to install and sign in to Intune Company Portal. For the relevant guide, please visit the school website:

<https://nundahss.eq.edu.au/curriculum/iPad-program/parent-setup-guides>

If you have any questions, or need support with these guides, please contact us using the details below.